

DATALOGIC - S65-V - COLOUR SENSOR

S65-PA-5-V09-PPP

Colour sensor 3xPNP, 5-45mm, M12 connector

- 3 independent NPN or PNP outputs and RS 485 serial interface
- LED with white light and RGB receiver
- Reaction time of 335 µs
- 2 push-button easy setting and 4 digit display



PRODUCT DESCRIPTION

The S65-V colour sensors offer the best performances for colour detection in compact housing. The S65-V is suitable for automatic packaging applications, quality control and part checking in the production process. The sensor can memorise and recognise 3 colours on 3 independent channels. The auxiliary functions include key-lock and synchronisation with external events through a specific input. The control panel presents two setting push-buttons, outputs LEDs and a 4-digit display for functioning messages and sensor configuration. Complete remote control is possible for the version with the RS485 serial interface.

Features & Benefits:

- White emission
- C or C+I selectable functioning mode
- Teach-in push-button and display 4 digits indicator
- 1.5KHz switching frequency
- RS485 serial interface

Applications:

- Packaging lines
- Sorting
- Wood working machines
- Glass working machines
- Automotive

SPECIFICATIONS

Approvals	CE, UL
Dimension (mm)	50 x 50 x 25
Distance Max	45 mm
Distance Min	5 mm
Electrical connection	M12 8 pole connector

IP Class	IP67
LED indicator	Yes
Lens material	Glass
Light type	White LED
Material of body	ABS plastic
Output	PNP
Output current max	0.1 A
Photocell technology	Color sensor
Power consumption max	0.06 A
Reaction time	0.335 ms
Sensitivity setting	Yes
Supply voltage	10-30 V DC
Temperature range bearing, from	-20 °C
Temperature range bearing, to	70 °C
Temperature range from	-10 °C
Temperature range to	55 °C
Type of light	LED
Weight	100 g

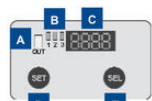

- A** Output 'OR' function LED
- B** Output status LEDs
- C** 4 digit display
- D** SET push-button
- E** SEL push-button
- F** M12 connector output, orientable on two positions

S65-PA-5

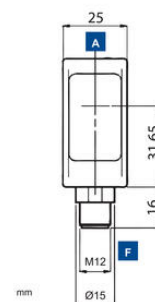
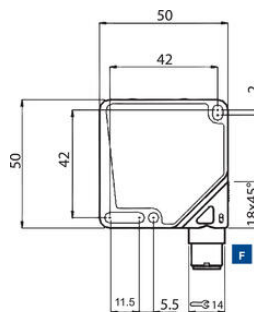
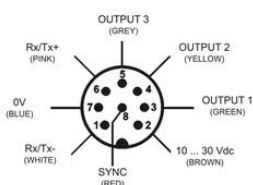

Versions and options: refer to **MODEL SELECTION TABLE**

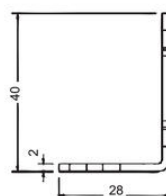
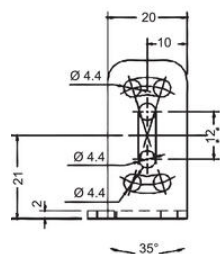
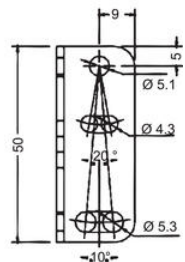
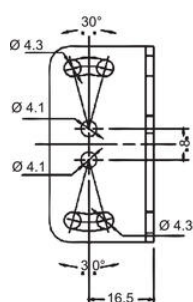
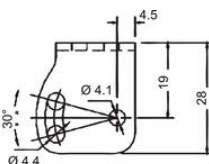
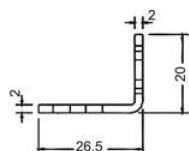

- A** Output 'OR' function LED
- B** Output status LEDs
- C** 4 digit display
- D** SET push-button
- E** SEL push-button
- F** M12 connector output, orientable on two positions

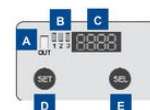

S65-PA-5

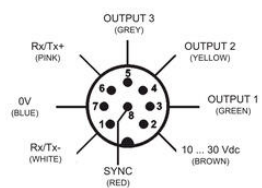

Versions and options: refer to **MODEL SELECTION TABLE**

