

## HONSBERG - LABO XF SERIES FLOW METER

Dynamic diaphragm (flap)

XF-008GMI015

Flow sensor 1/4", 1-15 l/min, 4-20mA

- For liquids up to 16 bar
- Flow from 1 l/min. to 80 l/min.
- Connection from 1/4" to 3/4"
- Housing in PPS or stainless



### PRODUCT DESCRIPTION

Model XF is a compact flow sensor in PPS plastic or stainless for water applications. Measurement takes place via a spring mounted metal plate which gives a rapid response time, low pressure drop, and high accuracy. The design with no moving parts makes it suitable for applications where this is a requirement. XF can be simply combined with Honsberg's Omni- or Flex technology.

### SPECIFICATIONS

Flow Max l/min Double	120 l/min
Flow Range Max	15 l/min
Flow Range Min	1 l/min
IP Class	IP67
Load Max	100 mA
Material of body	PPS
Material of connection	Nickel-plated brass
Material of seals	Viton
Material tinplate	Stainless steel 1.4031k
Power Consumption	20 mA
Pressure Range Max	16 bar
Temperature range of media from	0 °C
Temperature range of media to	70 °C
Type of flow component	Flow Measuring

Weight	0.35 kg
Viscosity Max	1 cSt
Voltage DC max	30 V
Voltage DC min	10 V

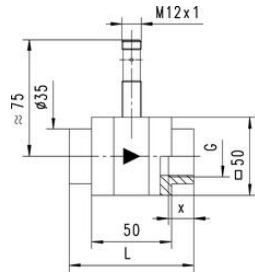
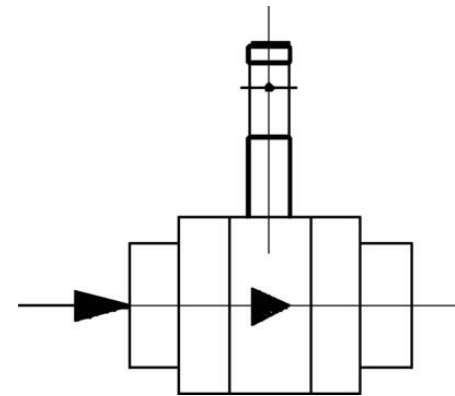

G"	L mm	X mm	Weight kg
1/4	74	12	0,60
3/8	74	12	0,60
1/2	78	14	0,60
3/4	82	16	0,65
1	82		0,70

PNP/ström-/spänning utgång

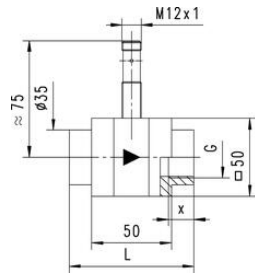
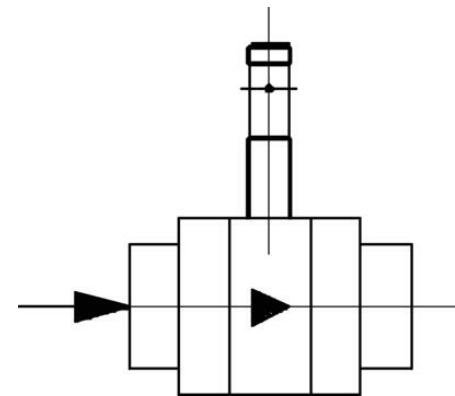
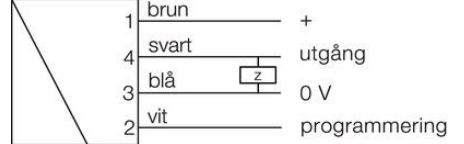

G"	L mm	X mm	Weight kg
1/4	74	12	0,60
3/8	74	12	0,60
1/2	78	14	0,60
3/4	82	16	0,65
1	82		0,70

PNP/ström-/spänning utgång

